

DRAWINGS AND SPECIFICATIONS ARE PROPERTY OF S.F. SCOTT MANUFACTURING. THIS DRAWING MAY NOT BE REPRODUCED IN WHOLE OR IN PART WITHOUT THE PRIOR WRITTEN CONSENT OF THE ENGINEERING DEPARTMENT

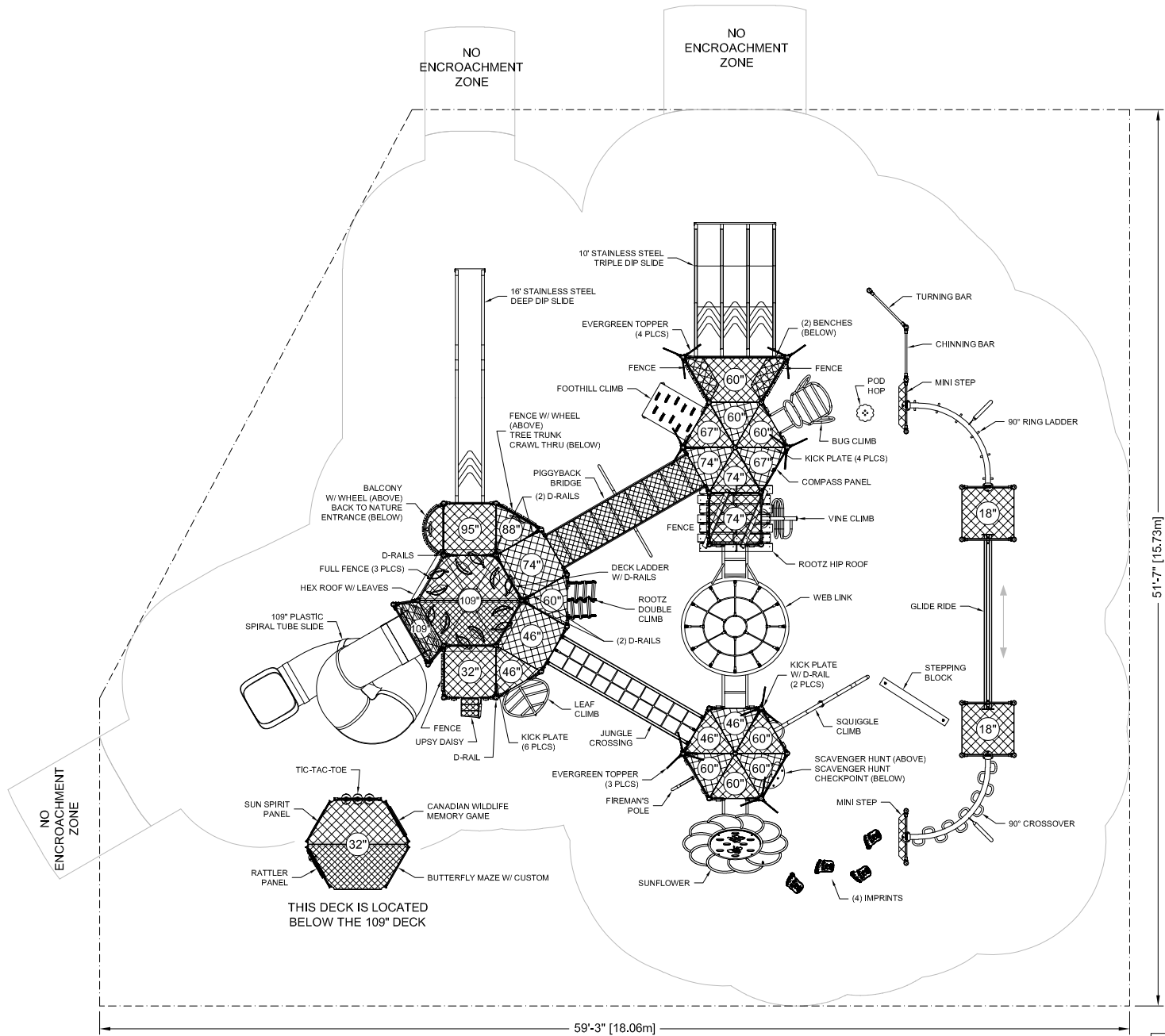

51'-7" [15.73m]

59'-3" [18.06m]



7	SAUCER TO POD HOP. UPDATE DEEP DIP SLIDE.	AS	26-SEP-23
6	UPDATE HEX ROOF W/LEAVES.	KH	09-MAR-21
5	CHANGED ROOTZ CLIMB TO ROOTZ DOUBLE CLIMB. ENTRY FENCES TO HALF FENCES	AV	13-JAN-21

BLUE IMP RECOMMENDS THAT SLIDES BE INSTALLED WITH SLIDE BEDS FACING BETWEEN NORTH AND EAST

- CONFORMS TO THE CAN/CSA-Z614-20 STANDARD "CHILDREN'S PLAYGROUND EQUIPMENT AND SURFACING"
- PERIMETER SHOWN REPRESENTS EXTENT OF REQUIRED SAFETY SURFACING. WIDTH OF BORDER MATERIAL MUST BE ADDED BEFORE EXCAVATION.

LAYOUT #: 105017-7
JOB #:
RECOMMENDED AGES: 5-12
PROTECTIVE SURFACING REQUIRED:
AREA: 2753 (sq.ft) PERIMETER: 209 (ft)
DRAWN BY: EH DATE: 5-DEC-16

724 - 14TH STREET S.W., MEDICINE HAT, AB. T1A 4V7
TOLL FREE: 1-800-661-1462 FAX: (403) 529-0851
E-MAIL: sales@blueimp.com WEBSITE: www.blueimp.com