

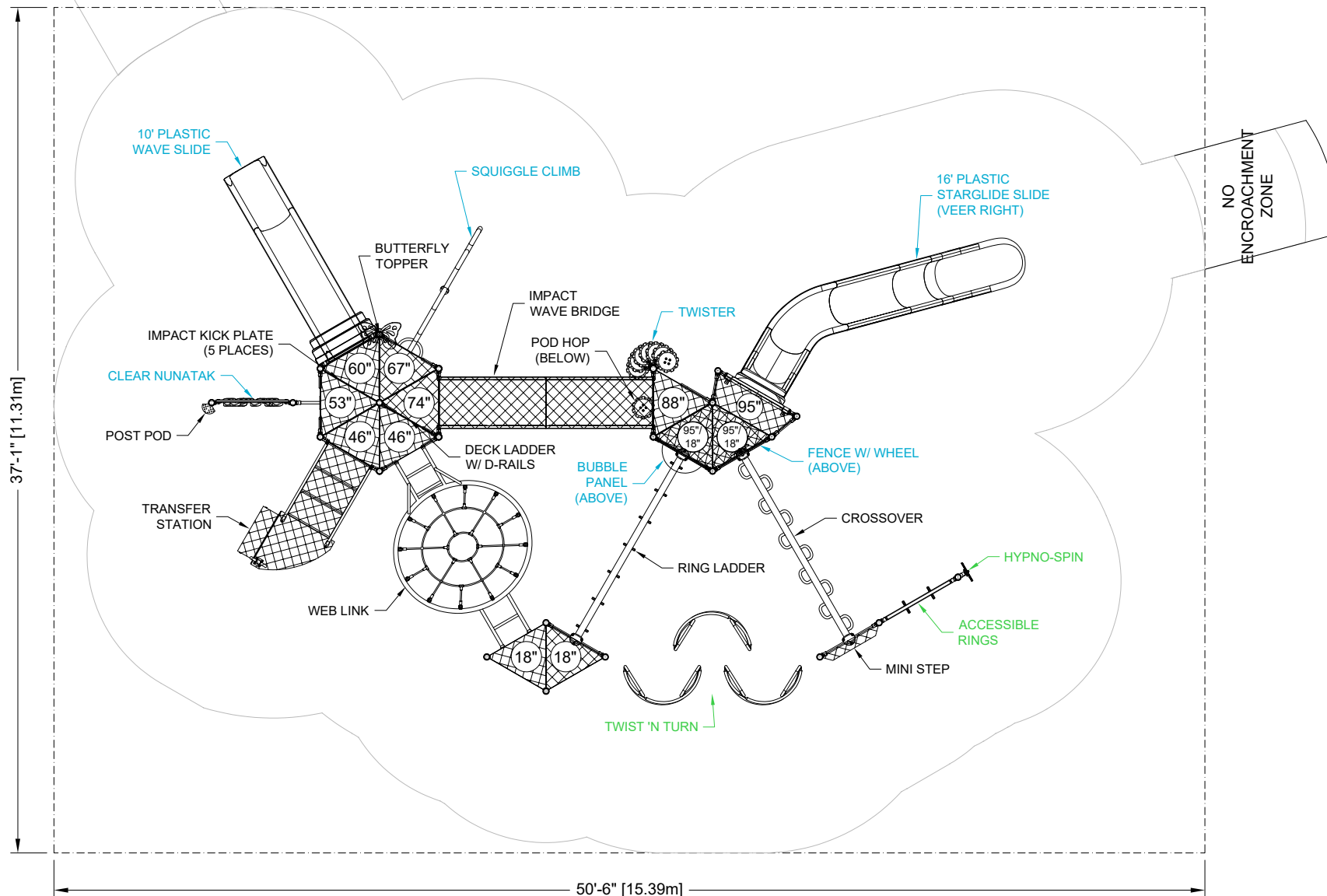

NO  
ENCROACHMENT  
ZONE

ANNEX 'H' COMPONENTS		
	REQUIRED	INCLUDED
ACCESSIBLE ELEVATED	5	7
ACCESSIBLE GROUND LEVEL	3	3



NO  
ENCROACHMENT  
ZONE



- CONFORMS TO THE CAN/CSA-Z614-20 STANDARD "CHILDREN'S PLAYGROUND EQUIPMENT AND SURFACING"
- PERIMETER SHOWN REPRESENTS EXTENT OF REQUIRED SAFETY SURFACING. WIDTH OF BORDER MATERIAL MUST BE ADDED BEFORE EXCAVATION.
- CONFORMS TO ANNEX 'H' OF THE CAN/CSA-Z614-20 STANDARD "CHILDREN'S PLAYGROUND EQUIPMENT AND SURFACING" (SUBJECT TO THE PRESENCE OF ACCESSIBLE SURFACING)

BLUE IMP RECOMMENDS  
THAT SLIDES BE INSTALLED  
WITH SLIDE BEDS FACING  
BETWEEN NORTH AND EAST

LAYOUT #: I16150  
JOB #:

RECOMMENDED AGES: 5-12

PROTECTIVE SURFACING REQUIRED:  
AREA: 1875 (sq.ft) PERIMETER: 176 (ft)

DRAWN BY: EH DATE: 17-JUL-25



724 - 14TH STREET S.W., MEDICINE HAT, AB. T1A 4V7  
TOLL FREE: 1-800-661-1462 FAX: (403) 529-0851  
E-MAIL: sales@blueimp.com WEBSITE: www.blueimp.com